

Automatic Leg Closing Workstation

- Patented Serial Bus Control System
- Automatic start & stop
- Electronic active edge guiding system
- Automatic backlatch
- Automatic thread cutter
- Automatic piece counter
- Automatic stacker
- Sews hemmed elastic and cuffed legs
- Most industrial overlock machines

DESCRIPTION

An electronically controlled leg closing workstation with automatic backlatch. This unit includes electronic active edge guiding system, providing the capability to sew either straight or contoured seams.

OPERATION

The operator folds the pant leg, aligns the hemmed or cuffed end and presents it to the presser foot. A photo cell senses the leading edge, drops the presser foot and begins the sewing cycle with a backlatch automatically. Electronic active edge guiding system controls the part during the sew cycle while the operator prepares the next pant leg. When the seam is complete, the machine stops, the thread chain is cut and stacked automatically.

Images may include options.

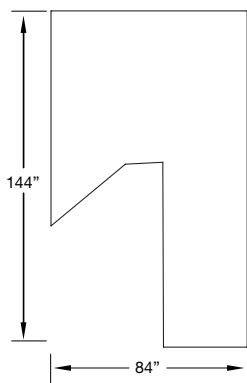
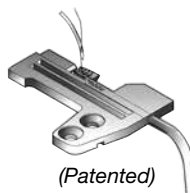
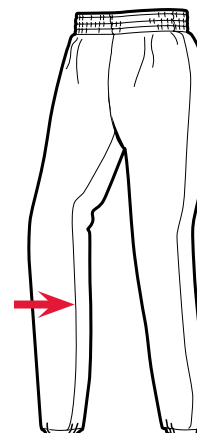

Footprint

SPECIFICATIONS

Voltage (v/ph/hz)	220v 1ph
Current (amps)	10
Air pressure (psi)	90
Air consumption (cfm)	13
Shipping weight (lbs)	1500
Shipping dimensions (w/l/h, inch)	120 x 60 x 65
PRODUCTION	
Pieces per hour	600

Depending on material and size of parts

www.atlatt.com • sales@atlatt.com

PATENTS: Our equipment may be covered by one or more patents. Please go to the following web page for an up-to-date patent list: www.atlatt.com/patents.php
© 2018 Atlanta Attachment Co. 17168042718

362 Industrial Park Drive
Lawrenceville, GA 30046 USA
+1 (770) 963-7369 • FAX +1 (770) 963-7641



Atlanta Attachment Company

The Company that
Sudden Service
built